

NOTES:

1. ROHS COMPLIANT
2. HEADER: PHENOLIC WITH FLAMMABILITY RATING UL 94V-0 OR BETTER.
3. STORAGE TEMPERATURE: -20°C TO +125°C
4. COMPLIANCE TO J-STD:
 - A. J-STD-002: SOLDERABILITY AT 245°C REFLOW PROFILE
 - B. J-STD-020: LEVEL 1, NO MOISTURE SENSITIVE
 - C. J-STD-075: R7, 245°C MAXIMUM THROUGH REFLOW SOLDER
5. TO ORDER TAPE & REEL PACKAGING ADD A "T" SUFFIX TO THE PART NUMBER(i.e T1712FNL BECOMES T1712FNLT).

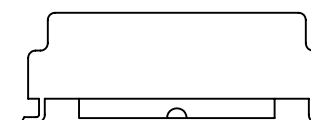
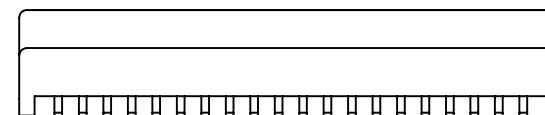
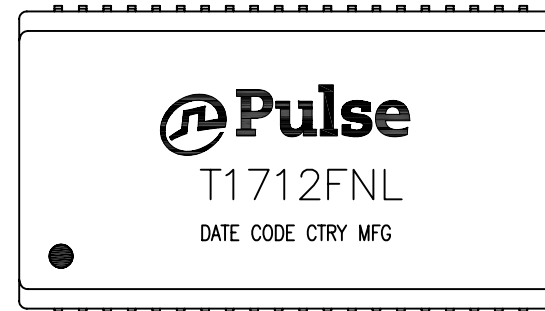

FINAL OUTLINE

© Copyright, 2014. Pulse Electronics Corp. All rights reserved. Pulse confidential & proprietary. (06/17/14)

PRODUCT DESCRIPTION	TLA DRAWING	PS DRAWING	SHEET	PART NO.	DATASHEET REV.
XFMR,OCT,T1,TOU,1:1.6/2,2CT:1,OH	T1712FNL-10	PS-2743.001-A	1 OF 3	T1712FNL	A

ELECTRICAL CHARACTERISTICS AT +25°C UNLESS OTHER SPECIFIED

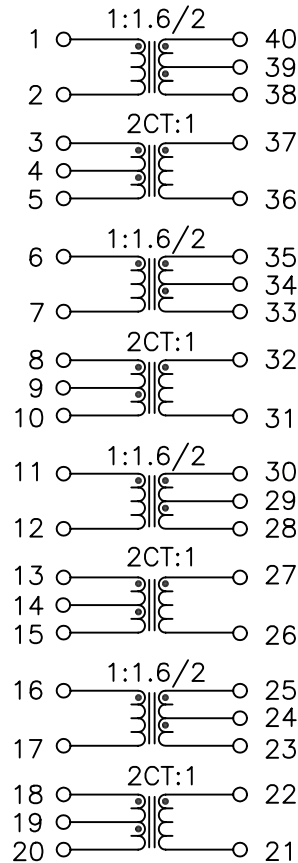

SCHEMATIC

PARAMETER	SPECIFICATIONS
OPERATING TEMPERATURE	0°C - 70°C
POLARITY	PER SCHEMATIC
TURNS RATIO @100 KHz, 0.02 VRMS	$\frac{(40-39)}{(1-2)} = \frac{(35-34)}{(6-7)} = \frac{(30-29)}{(11-12)} = \frac{(25-24)}{(16-17)} = 1.6 \pm 2\%$ $\frac{(40-38)}{(1-2)} = \frac{(35-33)}{(6-7)} = \frac{(30-28)}{(11-12)} = \frac{(25-23)}{(16-17)} = 2.0 \pm 2\%$ $\frac{(3-5)}{(37-36)} = \frac{(8-10)}{(32-31)} = \frac{(13-15)}{(27-26)} = \frac{(18-20)}{(22-21)} = 2.0 \pm 2\%$
INDUCTANCE (OCL) @10 KHz, 0.1 VRMS	(1-2)=(6-7)=(11-12)=(16-17) = 1.20 mH MINIMUM (37-36)=(32-31)=(27-26)=(22-21) = 1.20 mH MINIMUM
LEAKAGE INDUCTANCE (LL): @100 KHz, 0.01 VRMS	(1-2) WITH (40-38) SHORTED = 0.6 uH MAXIMUM (37-36) WITH (3-5) SHORTED = 0.6 uH MAXIMUM (6-7) WITH (35-33) SHORTED = 0.6 uH MAXIMUM (32-31) WITH (8-10) SHORTED = 0.6 uH MAXIMUM (11-12) WITH (30-28) SHORTED = 0.6 uH MAXIMUM (27-26) WITH (13-15) SHORTED = 0.6 uH MAXIMUM (16-17) WITH (25-23) SHORTED = 0.6 uH MAXIMUM (22-21) WITH (18-20) SHORTED = 0.6 uH MAXIMUM
INTERWINDING CAPACITANCE (CWW): @100 KHz, 0.1 VRMS	(1-2) TO (40-38) = 35 pF MAXIMUM (3-5) TO (37-36) = 35 pF MAXIMUM (6-7) TO (35-33) = 35 pF MAXIMUM (8-10) TO (32-31) = 35 pF MAXIMUM (11-12) TO (30-28) = 35 pF MAXIMUM (13-15) TO (27-26) = 35 pF MAXIMUM (16-17) TO (25-23) = 35 pF MAXIMUM (18-20) TO (22-21) = 35 pF MAXIMUM
DCR	(1-2) = (6-7) = (11-12) = (16-17) = 1.0 OHMS MAX (37-36) = (32-31) = (27-26) = (22-21) = 0.70 OHMS MAX (3-5) = (8-10) = (13-15) = (18-20) = 1.2 OHMS MAX (40-38) = (35-33) = (30-28) = (25-23) = 2.0 OHMS MAX
INPUT - OUTPUT ISOLATION	1500 VRMS FOR 60 SECONDS

© Copyright, 2014. Pulse Electronics Corp. All rights reserved. Pulse confidential & proprietary. (06/17/14)

PRODUCT DESCRIPTION	TLA DRAWING	PS DRAWING	SHEET	PART NO.	DATASHEET REV.
XFMR,OCT,T1,TOU,1:1.6/2,2CT:1,OH	T1712FNL-10	PS-2743.001-A	2 OF 3	T1712FNL	A

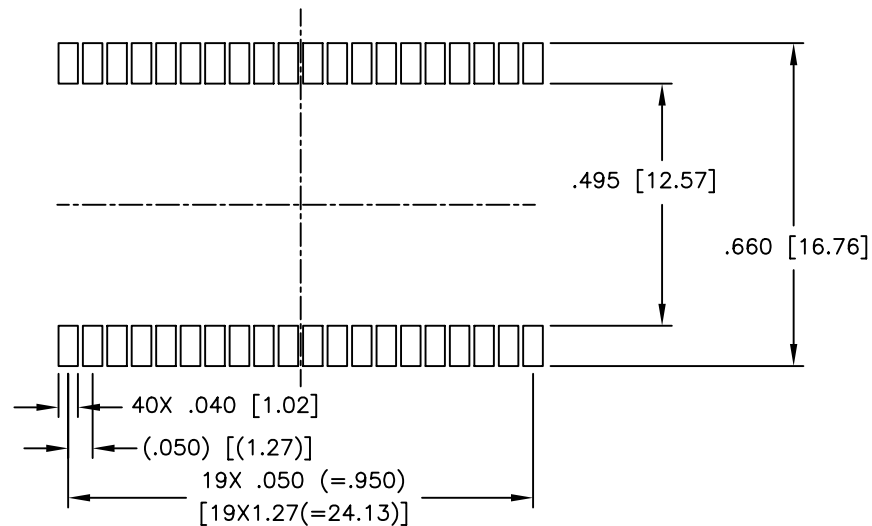
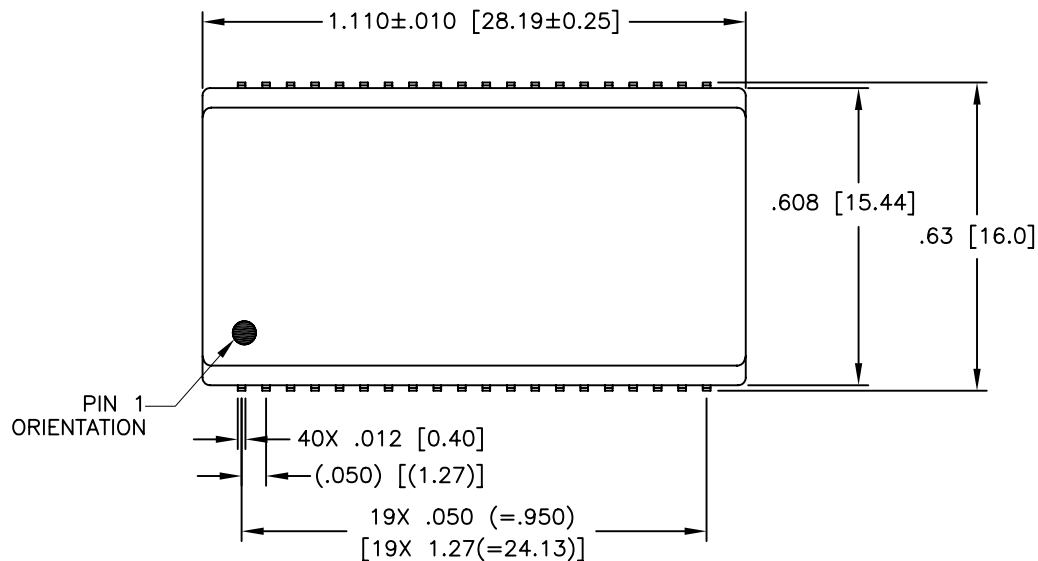

SUGGESTED PAD LAYOUT

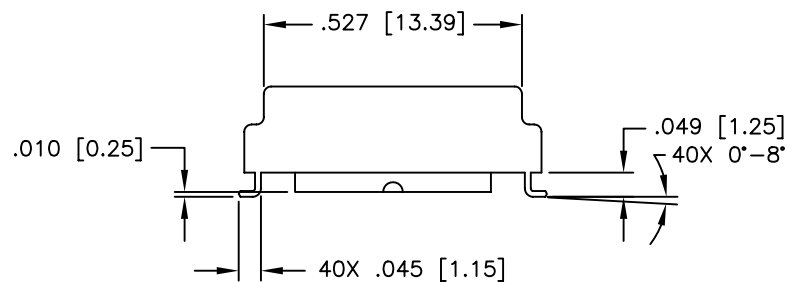
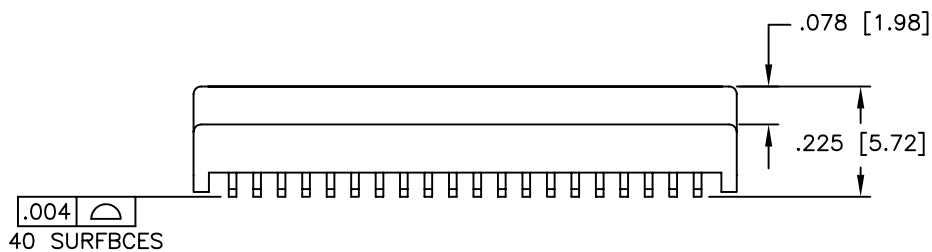

DIMENSIONS ARE IN INCHES [MILLIMETERS] WITH THE FOLLOWING TOLERANCES: [MILLIMETERS] ARE FOR REFERENCE ONLY.
 .XX= ± 0.01 [± 0.25]
 .XXX= ± 0.005 [± 0.13]

© Copyright, 2014. Pulse Electronics Corp. All rights reserved. Pulse confidential & proprietary. (06/17/14)

PRODUCT DESCRIPTION	TLA DRAWING	PS DRAWING	SHEET	PART NO.	DATASHEET REV.
XFMR,OCT,T1,TOU,1:1.6/2,2CT:1,OH	T1712FNL-10	PS-2743.001-A	3 OF 3	T1712FNL	A